

3×M1.2×0.25
DEPTH 3.5
P.C.D. 9.5±0.05

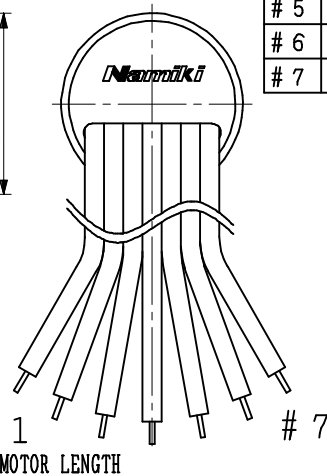
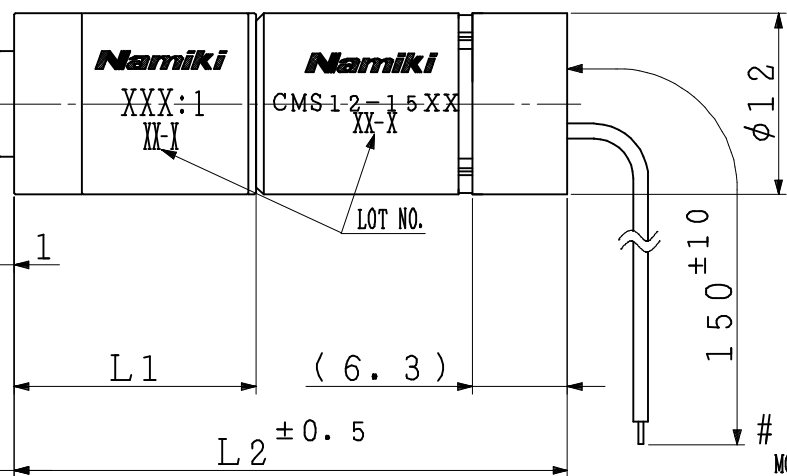
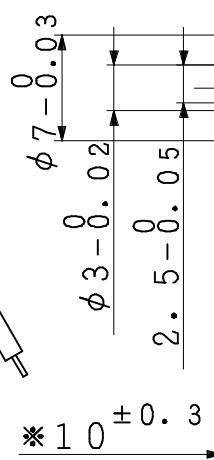
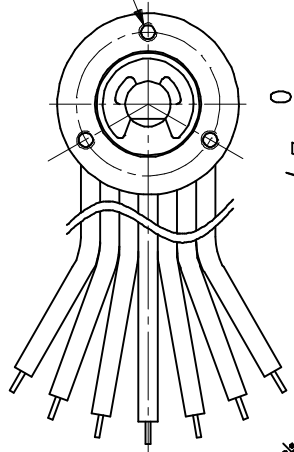

OPTICAL ENCODER
ELECTRICAL CONNECTIONS
PULSE/REV

| | |
|-----|---------------|
| # 1 | (MOTOR+) |
| # 2 | Vcc(DC5V±10%) |
| # 3 | Ch. A |
| # 4 | Ch. B |
| # 5 | Ch. Z |
| # 6 | GND |
| # 7 | (MOTOR-) |

NOTE 1) MARKED(*) IS OUTPUT SHAFT LENGTH MEASURED WHEN IT IS PUSHED TO MOTOR SIDE.
*印寸法は出力軸をモータ側に押しつけた時の値を示す。

2) LOT NO.
EXAMPLE) JANUARY, 2018

「18-A」

JANUARY:A, FEBRUARY:B...DECEMBER:L
1月:A、2月:B...12月:L

「-」 :MADE IN THAILAND
「-」有り :海外工場生産
「-」NONE :MADE IN JAPAN
「-」無し :国内工場生産

THE END TWO DIGIT OF CHRISTIAN YEAR
西暦年数末尾数字2桁

- 3) THE LEAD WIRE IS AWG28 UL4539.
リード線はAWG28 UL4539を使用する。
- 4) OUTSIDE DIAMETER IS NOT APPLIED TO THE CAULKING.
外径寸法公差はカシメ部を除く。
- 5) 3×M1.2 AND LEAD WIRE DRAWING POSITIONS ARE OUT OF DIMENSIONAL CONTROL.
3×M1.2とリード線引き出し角度は寸法管理外とする。

| GEAR RATIO | L1 | L2 |
|------------|------|------|
| 3.5 | 14.2 | 34.8 |
| 4.8 | 14.2 | 34.8 |
| 12 | 18 | 38.6 |
| 23 | 18 | 38.6 |
| 58 | 21.8 | 42.4 |
| 107 | 21.8 | 42.4 |
| 509 | 25.7 | 44.3 |

| TOLERANCE | | | | △/× | | | | |
|--------------|--------|-----------|-----------|---------|-------|-----------------|---------|---------|
| DIMENSION(±) | | | ANGLE | △/× | | | | |
| | 0 | 1 | 2 | 3 | | | | |
| L≤6 | 0.05 | 0.1 | 0.1 | 0.2 | ±1° | | | |
| 6<L≤30 | 0.1 | 0.1 | 0.2 | 0.25 | | | | |
| 30<L≤120 | 0.15 | 0.2 | 0.3 | 0.4 | | | | |
| 120<L | 0.2 | 0.3 | 0.5 | 1.2 | | | | |
| MATERIAL | FINISH | QTY. | SCALE | 2/1 | TYPE | CMS12-15 P 0 | DATE | NOTE |
| | | | UNIT | 1/1mm | TITLE | OUTLINE DRAWING | DRW. | CHK. |
| APPD. | CHK. | DSGN. | DRW. | DWG.NO. | | | REF.NO. | |
| | | Demachi | Demachi | CHK.NO. | | | REMARK | Rev. 00 |
| | | 15-Jan-18 | 15-Jan-18 | | | | | |