

OPTICAL ENCODER
ELECTRICAL CONNECTIONS
PULSE/REV

| | |
|-----|----------------------------|
| # 1 | (MOTOR+) |
| # 2 | V _{cc} (DC5V±10%) |
| # 3 | Ch. A |
| # 4 | Ch. B |
| # 5 | Ch. Z |
| # 6 | GND |
| # 7 | (MOTOR-) |

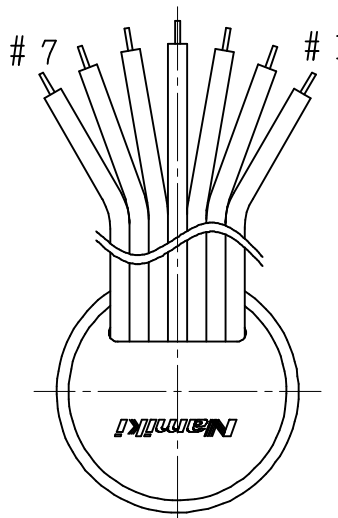
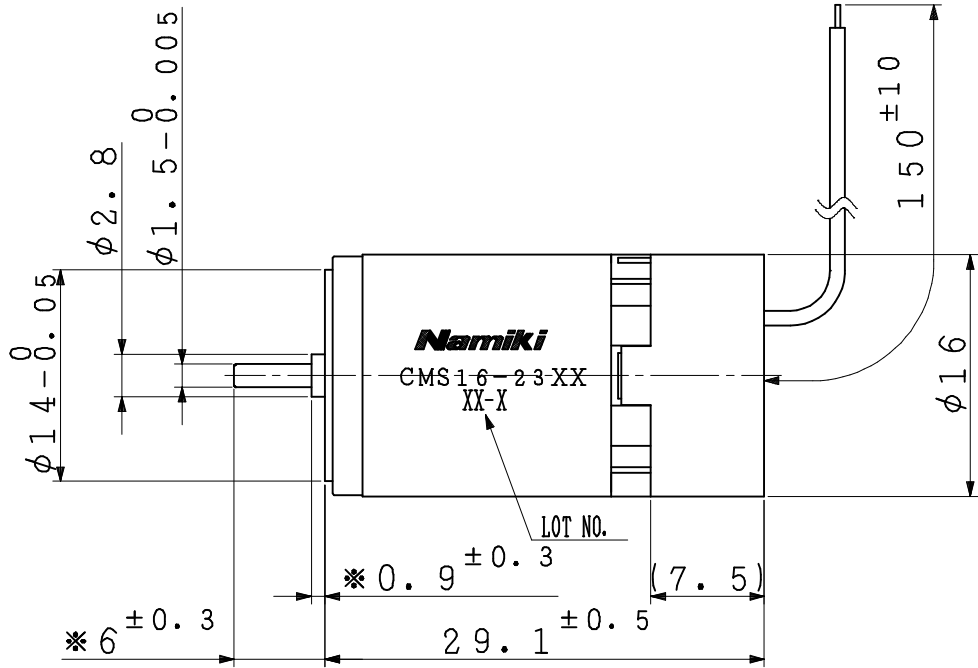
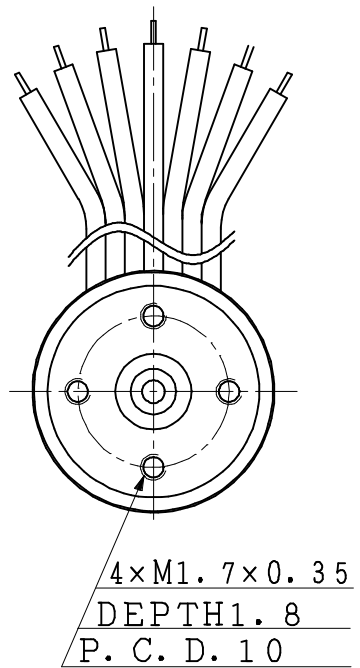

NOTE 1) MARKED(*) IS SHAFT LENGTH MEASURED WHEN IT IS PUSHED TO MOTOR SIDE.

*印寸法はシャフトをモータ側に押しつけた時の値を示す。

2) LOT NO.

EXAMPLE) JANUARY, 2018

「18=A」

JANUARY:A, FEBRUARY:B...DECEMBER:L
1月:A、2月:B...12月:L

「-」 :MADE IN THAILAND

「-」有り :海外工場生産

「-」NONE :MADE IN JAPAN

「-」無し :国内工場生産

THE END TWO DIGIT OF CHRISTIAN YEAR
西暦年数末尾数字2桁

3) THE LEAD WIRE IS AWG28 UL3302.

リード線はAWG28 UL3302を使用する。

4) OUTSIDE DIAMETER IS NOT APPLIED TO THE CAULKING.

外径寸法公差はカシメ部を除く。

5) 4×M1.7 AND LEAD WIRE DRAWING POSITIONS ARE OUT OF DIMENSIONAL CONTROL.

4×M1.7とリード線引き出し角度は寸法管理外とする。

| TOLERANCE | | | | △/× | | | | |
|--------------|--------|----------|----------|---------|-------|-----------------|---------|--|
| DIMENSION(±) | | | ANGLE | △/× | | | | |
| | 0 | 1 | 2 | 3 | △/× | | | |
| L≤6 | 0.05 | 0.1 | 0.1 | 0.3 | △/× | | | |
| 6<L≤30 | 0.1 | 0.1 | 0.2 | 0.5 | △/× | | | |
| 30<L≤120 | 0.15 | 0.2 | 0.3 | 0.8 | △/× | | | |
| 120<L | 0.2 | 0.3 | 0.5 | 1.2 | △/× | | | |
| | | | | | ±1° | | | |
| MATERIAL | FINISH | QTY. | SCALE | 2/1 | TYPE | CMS16-23 | 0 | |
| | | | UNIT | 1/1mm | TITLE | OUTLINE DRAWING | | |
| APPD. | CHK. | DSGN. | DRW. | DWG.NO. | | | | |
| | | Demachi | Demachi | REF.NO. | | | | |
| | | 30Jan'18 | 30Jan'18 | CHK.NO. | | REMARK | Rev. 00 | |